

**CEAG Products**  
**Explosion protected floodlights**

**CROUSE-HINDS**  
**SERIES**



## **PXLED - Power Floodlight Series for Hazardous Areas**

Explosion-protected LED floodlight series for Zone 1, 2, 21 and 22



**EATON**

*Powering Business Worldwide*



# Ex-Floodlight PXLED

(Ex-Zone 1, 2, 21 and 22)

## Lighting under harsh conditions

The new modular LED floodlight series PXLED is suited for nearly every kind of lighting task in hazardous areas, including applications in On- and Off-shore, heavy industrial, chemical, petrochemical, oil and gas, pharmaceuticals, shipyards, dockyards, power generation, paper mills and wastewater treatment indoor and outdoor with potentially explosive areas under harsh conditions like vibrations, dust, moisture or corrosive atmospheres and extreme temperatures. The PXLED comes with a standard U-shaped mounting bracket for ceiling and wall mounting

## Replacement of conventional light fittings up to 600 W

With a luminous flux from 5,000 lm up to 32,000 lm this floodlight series can be used to replace nearly every floodlight with conventional light sources with an equivalent power consumption from 70 W up to 600 W.

## High efficient LED technology

High efficient power LED module with 110 Lumen/Watt enables up to 70 % energy-cost savings compared to conventional HID lamp.

## Safety first

All PXLED multi-module floodlights from size 10L to 30L are equipped with a multichannel LED driver. This driver provides for each LED-module a separate power channel circuit. Even if one circuit fails, all other LED-modules are still working.

## Modular design - just use the size you need

Thanks to the modular design of the PXLED series you can exactly choose the lumen output you need. There is no need to over/underdesign your lighting project. Six sizes are available from nominal 5,000 lm to more than 30,000 lm with a step-wide of 5000 lm.

## Easy to install

A stainless steel swivel bracket with adjustable setting angle allows an easy alignment of the floodlight. A fixing screw



secures the alignment. The swivel bracket provides up to 5 Ø13 mm fixing holes for a safe assembly.

Together with two cable gland a large terminal compartment in Ex-e design allows cost saving through-wiring without additional terminal boxes.

The used Ex-e terminals can



clamp up to 6 mm<sup>2</sup> wiring.

Internal and external PE-terminals allows nearly all cabling



technique.



# 5 YEAR WARRANTY

## Features

- High efficiency: up to 110 lm/W
- Operating temperature -50 °C up to +55 °C
- Suitable for Explosion Group IIC / IIIC environment
- Broad range of light output from 5,000 lm up to 32,000 lm
- Wide and narrow beam pattern
- Long lifetime
- Ex-e compartment for driver & terminal for easy installation and maintenance



## Designed for long lifetime

High ambient temperatures can drive the LED chip-temperature into a not permissible range. This would reduce the life-span of the LEDs tremendously. Eaton provides an enclosure design with large cooling pipes and a innovated heat reduction



design.

Tests done under the worst test conditions have shown that the LED-chip temperature is always below critical values. The designed life span for the LED (L80) is more than 60,000 h even at +55°C ambient temperature

The Eaton-LED driver is especially designed for the harsh conditions of hazardous environments. According to EN 61000-4-5 an electronic device must withstand a surge pulse of 1 kV between L - N, our LED driver is designed to withstand 4 kV between L - N and L, N - PE.



All electronic components with self-heating are over dimensioned to ensure a maximum maintenance-free period. The driver has an own Ex-certification "q" and is mounted within the Ex-e compartment.

In the very unlikely cause of an driver failure this unit can be changed separately from the floodlight.

## Light distribution for various applications

Beside the various lumen output packages different light distributions can be realized with the PXLED-series.

A wide beam pattern as well as a narrow beam pattern is realized by the use of special designed lens caps for the LEDs. With a light transmission factor of more that 90 % we are able to offer a system efficiency of more than 110 lm/W.

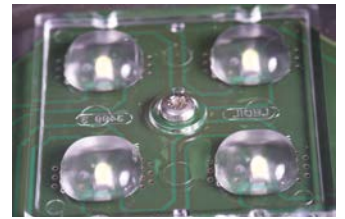

wide beam lens caps

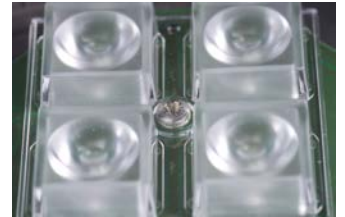

narrow beam lens caps

## Type key for PXLED floodlight series

### PXLED 10L A 7 57 C T0 E01

Type of fitting:	Size of fitting <sup>1)</sup> :	Light distribution:	CRI <sup>2)</sup> :	CCT <sup>3)</sup> :	front glass:	Terminals:	Cable entries/glands:
PXLED	5L = 5000 lm 10L=10000 lm 15L=15000 lm 20L=20000 lm 25L=25000 lm 30L=30000 lm	A = wide beam B = narrow beam	7 = CRI >70 X = other on request	57 = 5700 K XX = other on request	C = clear F = frosted on request	T0 = type 2410 - max. 6 mm <sup>2</sup> TX= others on request	E01= 2 x M25 metal gland type ADE 1F2 E08= 1 x M25 plastic threaded plug, 1 x dust cap M25 EXX= others on request

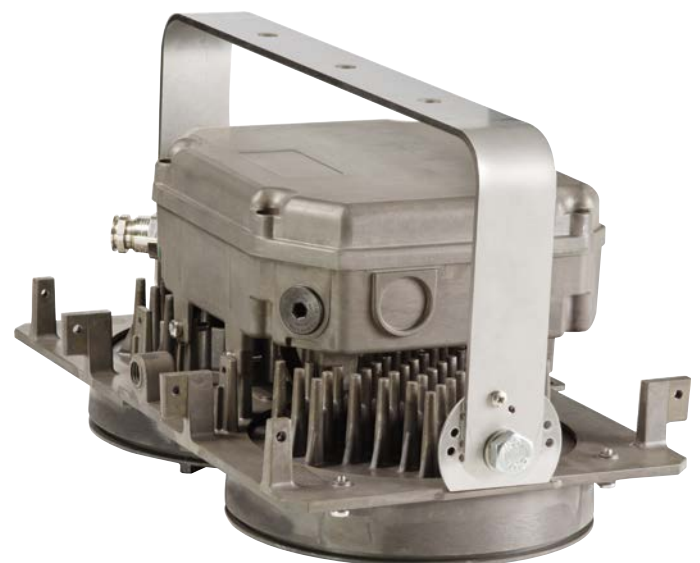
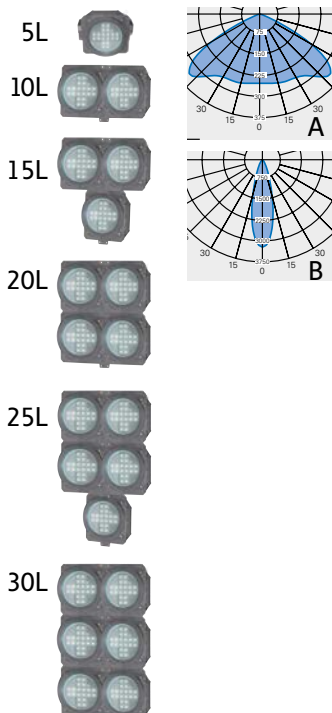

1) the lumen value is a design value and will not show the actual lumen output  
2) CRI = Colour Rendering Index  
3) CCT= Correlated Colour Temperature



# Ordering details

PXLED for Ex-Zone 1, 2, 21 and 22

## Ordering details PXLED

	Type	Lamp / illuminant	Light distribution	Description / Power	Cable glands	Order No..
	PXLED 5L B 757 C E01	LED system 5.386 lm	narrow beam	LED floodlight with swivel bracket 49 W	2 x M25 metal cable gland ADE 1F2 for Ø 10 - 17 mm	<b>1 3042 110 001</b>
	PXLED 5L B 757 C E08				1 x M25 treaded plug, 1 x dust cap M25	<b>1 3042 110 008</b>
	PXLED 5L A 757 C E01	LED system 5.207 lm	wide beam	LED floodlight with swivel bracket 49 W	2 x M25 metal cable gland ADE 1F2 for Ø 10 - 17 mm	<b>1 3042 111 001</b>
	PXLED 5L A 757 C E08				1 x M25 treaded plug, 1 x dust cap M25	<b>1 3042 111 008</b>
	PXLED 10L B 757 C E01	2 LED systems 10.772 lm	narrow beam	LED floodlight with swivel bracket 98 W	2 x M25 metal cable gland ADE 1F2 for Ø 10 - 17 mm	<b>1 3042 210 001</b>
	PXLED 10L B 757 C E08				1 x M25 treaded plug, 1 x dust cap M25	<b>1 3042 210 008</b>
	PXLED 10L A 757 C E01	2 LED systems 10.414 lm	wide beam	LED floodlight with swivel bracket 98 W	2 x M25 metal cable gland ADE 1F2 for Ø 10 - 17 mm	<b>1 3042 211 001</b>
	PXLED 10L A 757 C E08				1 x M25 treaded plug, 1 x dust cap M25	<b>1 3042 211 008</b>
	PXLED 15L B 757 C E01	3 LED systems 16.158 lm	narrow beam	LED floodlight with swivel bracket 147 W	2 x M25 metal cable gland ADE 1F2 for Ø 10 - 17 mm	<b>1 3042 310 001</b>
	PXLED 15L B 757 C E08				1 x M25 treaded plug, 1 x dust cap M25	<b>1 3042 310 008</b>
	PXLED 15L A 757 C E01	3 LED systems 15.621 lm	wide beam	LED floodlight with swivel bracket 147 W	2 x M25 metal cable gland ADE 1F2 for Ø 10 - 17 mm	<b>1 3042 311 001</b>
	PXLED 15L A 757 C E08				1 x M25 treaded plug, 1 x dust cap M25	<b>1 3042 311 008</b>
	PXLED 20L B 757 C E01	4 LED systems 21.544 lm	narrow beam	LED floodlight with swivel bracket 196 W	2 x M25 metal cable gland ADE 1F2 for Ø 10 - 17 mm	<b>1 3042 410 001</b>
	PXLED 20L B 757 C E08				1 x M25 treaded plug, 1 x dust cap M25	<b>1 3042 410 008</b>
	PXLED 20L A 757 C E01	4 LED systems 20.828 lm	wide beam	LED floodlight with swivel bracket 196 W	2 x M25 metal cable gland ADE 1F2 for Ø 10 - 17 mm	<b>1 3042 411 001</b>
	PXLED 20L A 757 C E08				1 x M25 treaded plug, 1 x dust cap M25	<b>1 3042 411 008</b>
	PXLED 25L B 757 C E01	5 LED systems 26.930 lm	narrow beam	LED floodlight with swivel bracket 245 W	2 x M25 metal cable gland ADE 1F2 for Ø 10 - 17 mm	<b>1 3042 510 001</b>
	PXLED 25L B 757 C E08				1 x M25 treaded plug, 1 x dust cap M25	<b>1 3042 510 008</b>
	PXLED 25L A 757 C E01	5 LED systems 26.035 lm	wide beam	LED floodlight with swivel bracket 245 W	2 x M25 metal cable gland ADE 1F2 for Ø 10 - 17 mm	<b>1 3042 511 001</b>
	PXLED 25L A 757 C E08				1 x M25 treaded plug, 1 x dust cap M25	<b>1 3042 511 008</b>
	PXLED 30L B 757 C E01	6 LED systems 32316 lm	narrow beam	LED floodlight with swivel bracket 294 W	2 x M25 metal cable gland ADE 1F2 for Ø 10 - 17 mm	<b>1 3042 610 001</b>
	PXLED 30L B 757 C E08				1 x M25 treaded plug, 1 x dust cap M25	<b>1 3042 610 008</b>
	PXLED 30L A 757 C E01	6 LED systems 31242 lm	wide beam	LED floodlight with swivel bracket 294 W	2 x M25 metal cable gland ADE 1F2 for Ø 10 - 17 mm	<b>1 3042 611 001</b>
	PXLED 30L A 757 C E08				1 x M25 treaded plug, 1 x dust cap M25	<b>1 3042 611 008</b>



PXLED 5L

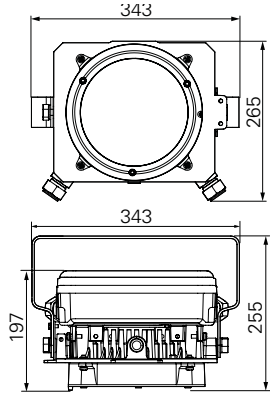

PXLED 15L

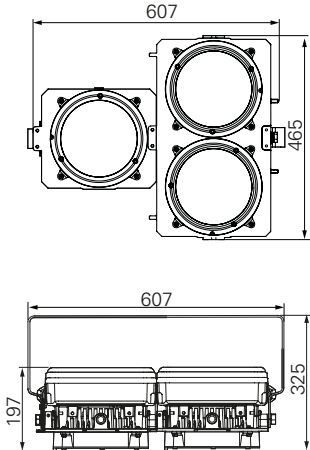

PXLED 25L

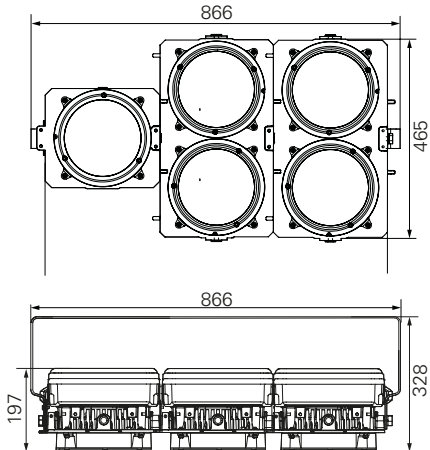

PXLED 10L

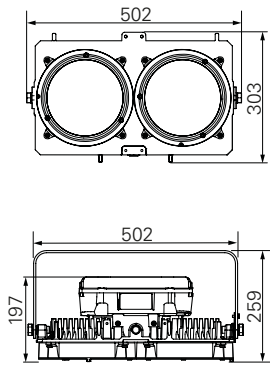

PXLED 20L

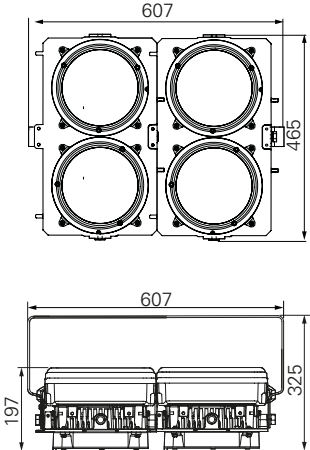

PXLED 30L

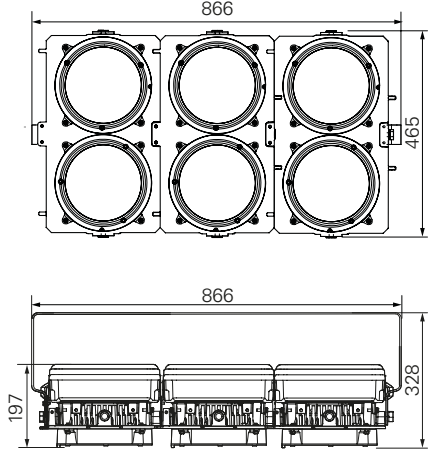

Dimensions in mm

Swivel bracket

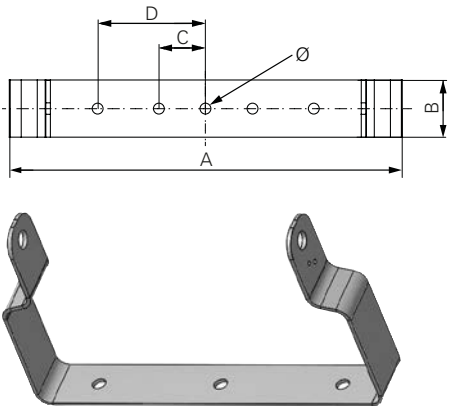

Swivel bracket for PXLED - Dimensions

Dimensions in mm	A	B	C	D	Ø
PXLED 05	343	50	120	-	13
PXLED 10	476	50	120	-	13
PXLED 15	606	50	120	-	13
PXLED 20	606	50	120	-	13
PXLED 25	858	50	120	270	13
PXLED 30	858	50	120	270	13



# Technical data, Polar curve,

PXLED for Ex-Zone 1, 2, 21 and 22

## Technical data

	PXLED 5L	PXLED 10L	PXLED 15L	PXLED 20L	PXLED 25L	PXLED 30L
Type Examination Certificate	applied for					
IECEX Certificate of conformity	applied for					
Marking accd. 2014/34/EU	Ⓔ II 2 G Ex db eb op is q IIC T4 Gb/ Ⓔ II 2 D Ex tb op is IIIC T100°C Db					
Marking accd. to IECEx	Ex db eb op is q IIC T4 Gb/ Ex tb op is IIIC T100°C Db					
Permissible ambient temperature	-50 °C up to +55 °C					
LED lifetime L80	>200,000 h @ 25 °C / 60,000 h @ +55 °C					
Driver lifetime C10	>100,000 h @ 25 °C / 60,000 h @ +55 °C					
Rated voltage	110 - 277 V AC / 120 - 277 V DC					
Rated current <sup>1)</sup>	0.24 A	0.48 A	0.72 A	0.96 A	1.20 A	1.44 A
Frequency	0/50 - 60 Hz					
Power factor cos φ <sup>1)</sup>	≥ 0.95					
Circuit	Electronic driver					
Protection class	I					
Light colour / CRI	5700 K / R <sub>a</sub> >70 (other colours on request)					
Enclosure colour	dark grey					
Connecting terminals	6 poles standard (L, L1, L2, L3, N, PE / up to 6 mm <sup>2</sup> / others on request)					
Enclosure material	Anodized copper-free Aluminium					
Weight	9,9 kg	14,4 kg	24,3 kg	28,7 kg	38,5 kg	41,1 kg
Cable glands / gland plates / enclosure drilling	2 x M25 metal thread nickel plated (E01) or 1 x M25 threaded plug + 1 x M25 dust cap (E08) (others on request)					
Degree of protection accd. to EN 60529	IP66/67					
Protective cover / protective bowl	Toughened glass, clear (frosted on request)					
Swivel bracket	AlSi 316L stainless steel					

<sup>1)</sup> Typical value at 230 V

## Polar curve

Polar curve PXLED 5L - 30L, narrow beam

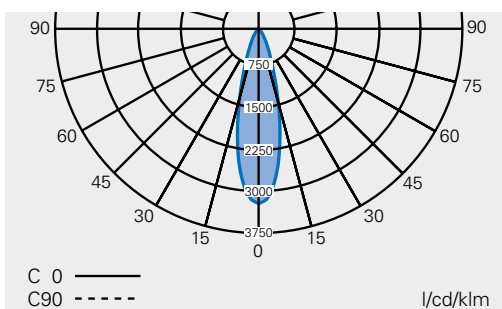

Polar curve PXLED 5L - 30L, wide beam

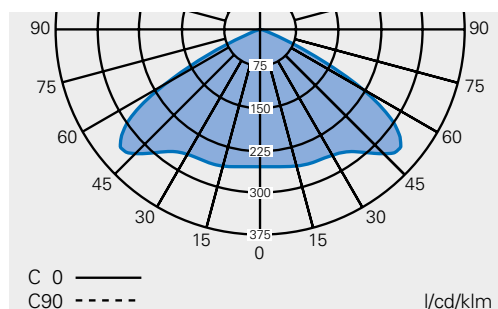



Marine/Offshore



Cold environment



Industrial production area

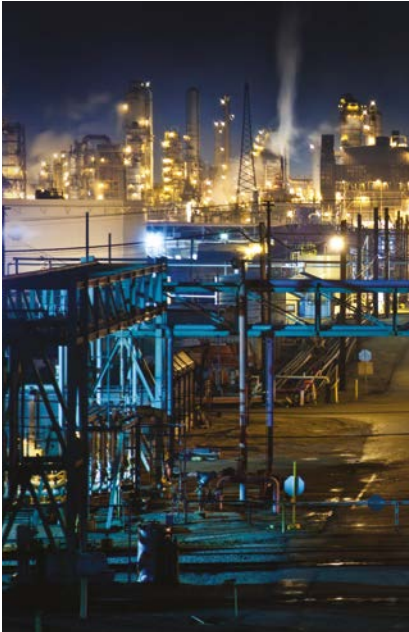

Heavy Industry



Oil & Gas



Pharmaceutical industry



Refineries



Extreme Conditions

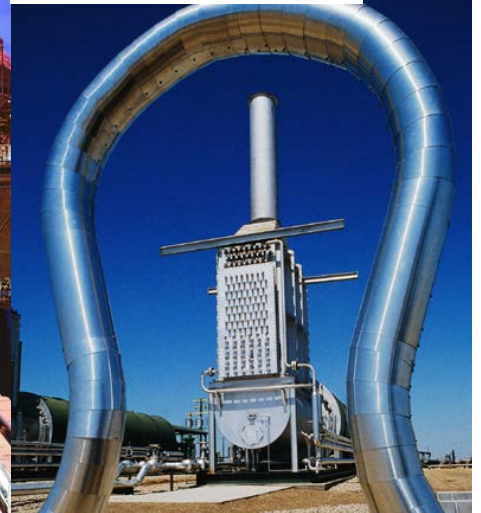

Chemical industry







Eaton's Crouse-Hinds Business

# The safety you rely on.

See the complete offering of Hazardous and Industrial Products at [www.crouse-hinds.de](http://www.crouse-hinds.de).

## U.S. (Global Headquarters): Eaton's Crouse-Hinds Business

1201 Wolf Street  
Syracuse, NY 13208

(866) 764-5454  
FAX: (315) 477-5179  
FAX Orders Only:  
(866) 653-0640

[CrouseCustomerCTR@Eaton.com](mailto:CrouseCustomerCTR@Eaton.com)

### For more information:

If further assistance is required, please contact an authorized Eaton Distributor, Sales Office, or Customer Service Department.

## Australia

Phone +61-2-8787-2777  
Fax +61-2-9609-2342  
[crousehindsanz@eaton.com](mailto:crousehindsanz@eaton.com)

## China

Phone +86-21-2899-3600  
Fax +86-21-2899-4055  
[ECHsales@eaton.com](mailto:ECHsales@eaton.com)

## Great Britain

Phone +44-247-630-89 30  
Fax +44-247-630-10 27  
[sales5@eaton.com](mailto:sales5@eaton.com)

## India

Phone +91-124-4683888  
Fax +91-124-4683899  
[cchindia@eaton.com](mailto:cchindia@eaton.com)

## Canada

Toll Free +1-800-265-0502  
Fax +1-800-263-9504  
Fax orders only:  
+1-866-653-0645

## Korea

Phone +82-2-3484-6783  
Fax +82-2-3484-6778  
[CCHK-sales@cooperindustries.com](mailto:CCHK-sales@cooperindustries.com)

## Mexico/Latin America/ Caribbean

Phone +52-555-804-4000  
Fax +52-555-804-4020  
[mxmercadotecnia@cooperindustries.com](mailto:mxmercadotecnia@cooperindustries.com)

## Spain

Phone +34-9-37362710  
Fax +34-9-37835055  
[sales.CCH.es@cooperindustries.com](mailto:sales.CCH.es@cooperindustries.com)

## Middle East (Dubai)

Phone +971-4-427-2522 / 2500  
Fax +971-4-429-8521  
[CHMEsales@Eaton.com](mailto:CHMEsales@Eaton.com)

## The Netherlands

Phone +31-10-2452145  
Fax +31-10-2452121  
[CHRD\\_mail@Eaton.com](mailto:CHRD_mail@Eaton.com)

## Norway

Phone +47-32-244600  
Fax +47-32-244646  
[CHLloffice@eaton.com](mailto:CHLloffice@eaton.com)

## Singapore:

Phone +65-6645-9888  
Fax +65-6297-4819  
[CHSI-Sales@Eaton.com](mailto:CHSI-Sales@Eaton.com)

## Turkey

Phone +90-216-464-20-20  
Fax +90-216-464-20-10  
[infoEGTurkey@eaton.com](mailto:infoEGTurkey@eaton.com)

## Russia

Phone +7-495 510-24-27  
Fax +7-495 510-24-28  
[info@cooper.ru.com](mailto:info@cooper.ru.com)  
[www.cooper-russia.ru](http://www.cooper-russia.ru)

## Eaton's Crouse-Hinds Business

Neuer Weg – Nord 49  
D-69412 Eberbach

Phone +49 (0) 6271/806-500  
Fax +49 (0) 6271/806-476  
E-mail [info-ex@eaton.com](mailto:info-ex@eaton.com)  
Internet [www.crouse-hinds.de](http://www.crouse-hinds.de)

## Eaton

1000 Eaton Boulevard  
Cleveland, OH 44122  
United States  
[Eaton.com](http://Eaton.com)

© 2017 Eaton Corporation  
All Rights Reserved  
Printed in Germany  
Publication No. BR 300 8000 xxxx  
January 2017

Changes to the products, to the information contained in this document, and to prices are reserved; so are errors and omissions. Only order confirmations and technical documentation by Eaton is binding. Photos and pictures also do not warrant a specific layout or functionality. Their use in whatever form is subject to prior approval by Eaton. The same applies to Trademarks (especially Eaton, Moeller, and Cutler-Hammer). The Terms and Conditions of Eaton apply, as referenced on Eaton Internet pages and Eaton order confirmations.

## Eaton's Crouse-Hinds Business

1201 Wolf Street  
Syracuse, NY 13208  
(866) 764-5454  
[CrouseCustomerCTR@Eaton.com](mailto:CrouseCustomerCTR@Eaton.com)

Eaton is a registered trademark.

All other trademarks are property of their respective owners.



Powering Business Worldwide